

TROUBLESHOOTING

PROBLEM	SOLUTION
Pitching machine motor will not start	<ol style="list-style-type: none"> 1) Power switch is off. Turn to BAT or AUTO. 2) Batteries are installed incorrectly. Check the + and - markings to make sure the batteries are properly aligned. 3) Batteries are drained. Install new LR20 1.5v batteries.
Pitching machine does not respond to the bat remote control	<ol style="list-style-type: none"> 1) Battery in the bat is drained. Install a new 6LR61 9v battery. 2) Pitching machine is out of range. Do not stand further than 8 metres away from the pitching machine. 3) Pitching machine switched to AUTO. Switch back to BAT.
Ball stuck inside the chute	<ol style="list-style-type: none"> 1) Do not stand in front of the pitching machine. 2) Turn off the pitching machine. 3) Insert a long probe from the top of the ball carriage to dislodge the ball from the flywheel. 4) Wait one minute to re-start the pitching machine for operation.

BATTERY INFORMATION:

- Adult assembly required.
- Batteries must always be inserted and removed by an adult.
- Take special care to ensure batteries are inserted correctly, observing (+) and (-) marks on battery and product.
- Do not attempt to recharge non-rechargeable batteries.
- Rechargeable batteries must be removed from toy before recharging.
- Removal and recharging of rechargeable batteries should be carried out by an adult.
- Avoid short circuiting the contacts in the battery compartment or the battery terminals.
- Remove exhausted batteries from product.
- Do not mix old (used) and new batteries or batteries of different types, e.g. rechargeable and alkaline.
- Do not attempt to power battery products by the introduction of main supply or separate power supplies, and do not attempt to plug any part of this product into the mains supply.
- Dispose of exhausted batteries safely and never dispose of batteries in a fire.
- Remove batteries from product after use or if storing for long periods.
- Periodically examine product for signs of damage. If any damage is found discontinue use and contact our Customer Services Department.
- Only use batteries of the same equivalent type to those recommended.
- Retain these instructions for future reference.
- Made in China.

The normal function of the product may be disturbed by Strong Electro Magnetic Interference. If so, simply reset the product to resume normal operation by following the instruction manual. In case the function could not resume, please use the product in another location.

WEEE INFORMATION:



Help the environment by disposing of your product and batteries responsibly. The wheeled bin symbols indicate that the product and batteries must not be disposed of in the domestic waste, as they contain substances which can be damaging to the environment and health. Please use designated collection points or recycling facilities when disposing of the item or batteries.

More information can be found on: <http://www.recycle-more.co.uk> or <http://www.recyclenow.com>

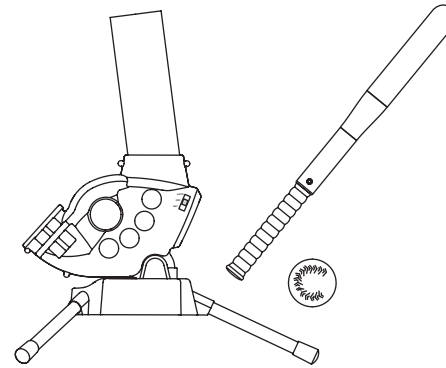

GetGo®



Worlds Apart Ltd.
St. Columb Major
Business Park,
Cornwall
TR9 6SX
United Kingdom

CUSTOMER CARE
FREEPHONE: 0800 389 8591 (UK only)
www.worldsapart.com
customercare@worldsapart.com

Design & © 2015 Worlds Apart Ltd. All Rights Reserved.

INS:186LAS 01/12/15

ADULT ASSEMBLY ONLY - IMPORTANT INFORMATION:

Caution:

- To be used under the supervision of an adult.
- Recommended age 8 years plus.
- Do not aim at the eyes or face.
- This product is intended for outdoor use only.
- Only use the plastic balls provided with the product.
- If balls, bat, or machine are broken in any way, discontinue use.
- All person(s) not batting should stand behind the pitching machine.
- Ensure you do not stand too close to the pitching machine.
- Do not use this product for any other purpose or with any other object or ball. Do not modify the pitching machine.
- Do not store outside.
- Avoid getting dirt, moisture or sand into the pitching machine.
- Replacement balls can be purchased through our Customer Care Service (UK ONLY).

PARTS LIST:

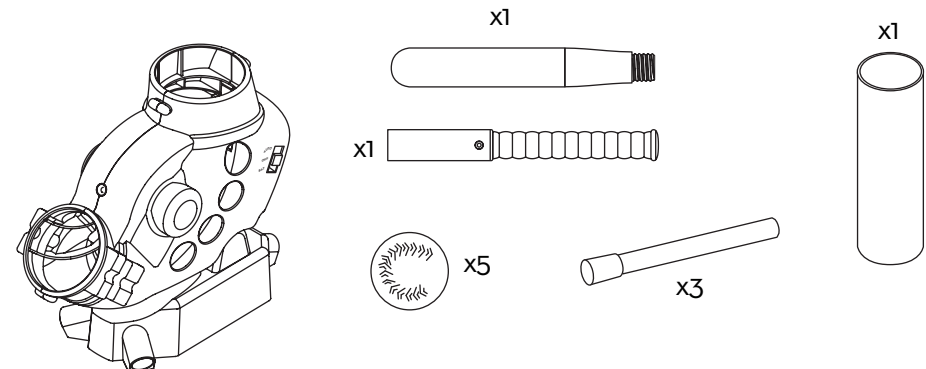

BATTERY INSTALLATION:

1. Unscrew the battery compartment screw with a crosshead screwdriver
2. Install 4 X LR20 / "D" size batteries 1.5V (not included) into the pitching machine base.
3. Install 1 x PP3 / 6LR61 9V battery into the bat handle.

Pitching Machine Base

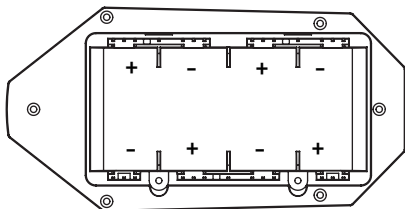

Install 4 X LR20 / "D" size batteries 1.5V following the polarity (+/-).

Bat Handle

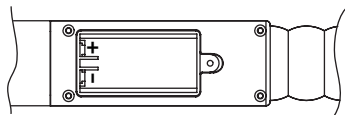

Install 1 x PP3 / 6LR61 9V following the polarity (+/-).

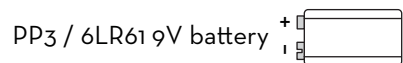

ASSEMBLY:

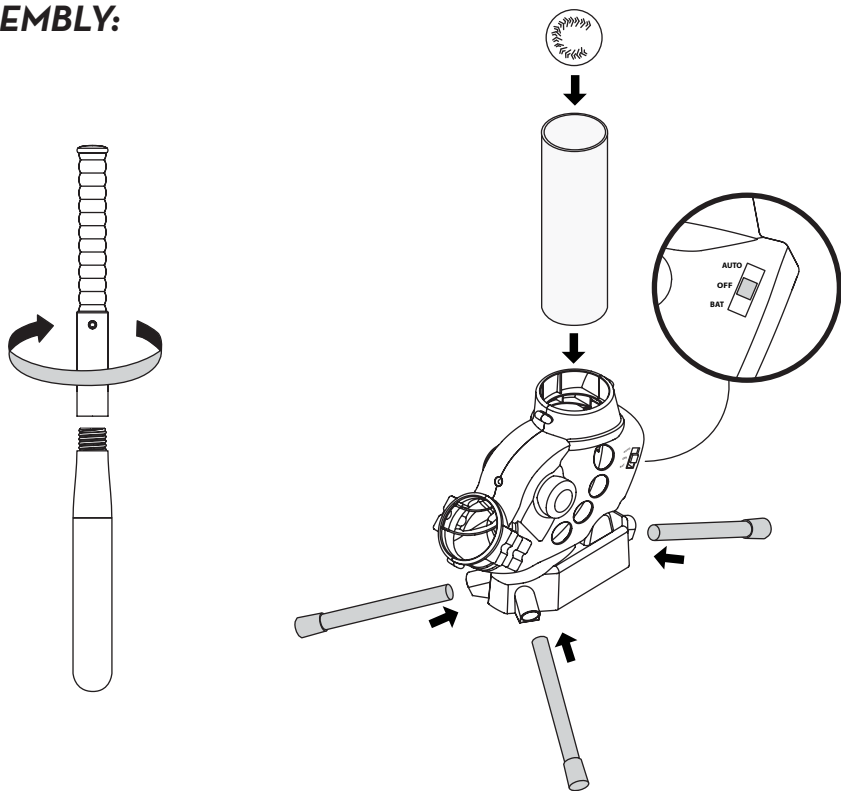

HOW TO USE:

1. The chute opening can rotate to 30, 40, 50, and 90 degree positions.
2. To use the button on the bat to control the pitches turn the OFF switch to BAT.
3. To have the machine pitch a ball every 8 seconds turn the OFF switch to AUTO.

ADVISED BATTING DISTANCES:

- > Pitcher angle: 30 degree - Stand 5 to 6 metres away from pitching machine.
- > Pitcher angle: 40 degree - Stand 6 to 7 metres away from pitching machine.
- > Pitcher angle: 50 degree - Stand 6 to 7 metres away from pitching machine.
- > Pitcher angle: 90 degree - Stand 1 to 2 feet either side of the pitching machine.
(Do not stand in front or behind the pitching machine)

